



City of Fitchburg
 Planning/Zoning Department
 5520 Lacy Road
 Fitchburg, WI 53711
 (608-270-4200)

REZONING APPLICATION

The undersigned owner, or owner's authorized agent, of property herein described hereby petitions to amend the zoning district map of the Fitchburg zoning ordinance by reclassifying from the B-H district to the B-G district the following described property:

1. Location of Property/Street Address: 5964 EXECUTIVE DRIVE

Legal Description - (Metes & Bounds, or Lot No. And Plat):

LOTS 8 & 9
FITCHBURG BUSINESS PARK

***Also submit in electronic format (MS WORD or plain text) by email to: planning@fitchburgwi.gov

2. Proposed Use of Property - Explanation of Request:

1,100 SQUARE FEET OF LEASED SPACE
FOR CHIROPRACTIC USE BUSINESS HIGHWAY
TO BUSINESS GENERAL

3. Proposed Development Schedule: APRIL 1, 2017

***Pursuant to Section 22-3(b) of the Fitchburg Zoning Ordinance, all Rezoning shall be consistent with the currently adopted City of Fitchburg Comprehensive Plan.

***Attach three (3) copies of a site plan which shows any proposed land divisions, plus vehicular access points and the location and size of all existing and proposed structures and parking areas. Two (2) of the three (3) copies shall be no larger than 11" x 17". Submit one (1) electronic pdf document of the entire submittal to planning@fitchburgwi.gov. Additional information may be requested.

Type of Residential Development (If Applicable): N/A

Total Dwelling Units Proposed: N/A No. of Parking Stalls: 109

Type of Non-residential Development (If Applicable):

Proposed Hours of Operation: 9AM - 7PM No. of Employees: 2

Floor Area: 1,100 No. of Parking Stalls: 109

Sewer: Municipal Private Water: Municipal Private

Current Owner of Property: BREAK AWAY SPORTS CENTER 288-9600

Address: 5964 EXECUTIVE DRIVE Phone No: 577-2047

Contact Person: MARK LANDGRAF

Email: MARK.LANDGRAF62@GMAIL.COM

Address: 2130 WEST LAWN AVE Phone No: 577-2047

Respectfully Submitted By: MADISON, WI 53711 MARK LANDGRAF

Owner's or Authorized Agent's Signature

Print Owner's or Authorized Agent's Name

PLEASE NOTE - Applicants shall be responsible for legal or outside consultant costs incurred by the City. Submissions shall be made at least four (4) weeks prior to desired plan commission meeting.

For City Use Only: Date Received: 1/21/2017 Publish: _____ and _____

Ordinance Section No. _____ Fee Paid: 4600.00

Permit Request No. RZ-2141-17

PADLEY-MCGANN Construction, Inc.
 2222 Wisconsin Avenue, Suite 5714, Bethesda, Maryland 20814-4122
 Phone: (301) 656-2222 Fax: (301) 656-2222

CARL RUEDEBUSCH & ASSOCIATES
 P.O. Box 7155, Madison, Wisconsin 53707
 Phone: (608) 249-2012 Fax: (608) 249-2032

MITCHELL ARCHITECT
 1746 Portage Road, Madison, Wisconsin 53704
 Phone: (608) 241-4444 Fax: (608) 241-4444

WALKWAY SPORTS CENTER
 1794 EXECUTIVE DRIVE, FITCHBURG, WISCONSIN

DATE: 6-10-96
 PROJECT NO. 9606

INDEX TO DRAWINGS

- 1A. SITE PLAN
- 1B. GRADING PLAN
2. FOUNDATION PLAN
3. FOUNDATION DETAILS
4. FLOOR PLAN
5. ENLARGED FLOOR PLAN
6. ENLARGED ELEVATIONS
7. VERTICAL WALL SECTIONS
8. VERTICAL WALL SECTIONS
9. VERTICAL WALL SECTIONS
10. STAIR SECTIONS
11. STAIR SECTIONS
12. STAIR SECTIONS

HANDICAPPED ACCESSIBLE SIGN

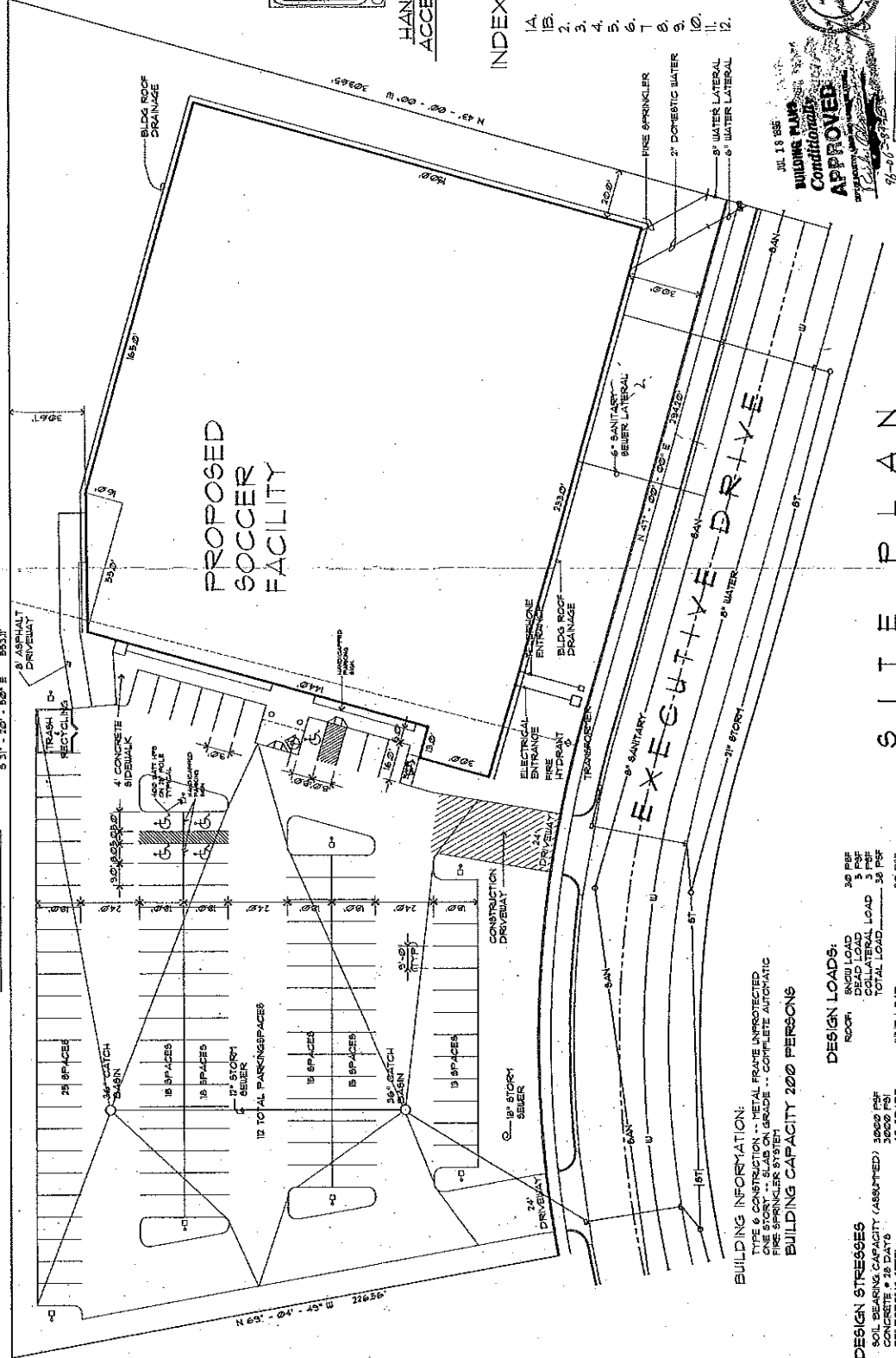
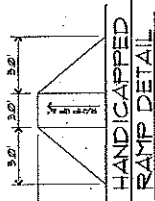
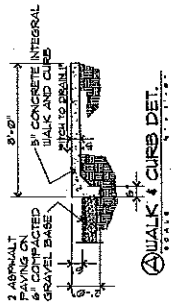

SITE PLAN
 SCALE 1\"/>

BUILDING INFORMATION:
 TYPE & CONSTRUCTION -- METAL FRAMING UNPROTECTED
 ONE STORY -- SLAB ON GRADE -- COMPLETE AUTOMATIC
 FINE SPRINKLER SYSTEM
BUILDING CAPACITY 2000 PERSONS

DESIGN STRESSES

SOIL BEARING CAPACITY (ASSUMED)	3000 PSF
CONCRETE # 28 DAYS	4000 PSF
STEEL	A 36
MISCELLANEOUS STEEL	

DESIGN LOADS:

ROOF	5 PSF
SNOW LOAD	30 PSF
FLOOR	5 PSF
CEILING	5 PSF
WIND LOAD	20 PSF
MEZZANINE	100 PSF
DEAD LOAD	15 PSF
TOTAL LOAD	

APPROVED
 JUL 19 1996
 BUILDING PLAN CONDITIONALLY APPROVED
 CITY OF FITCHBURG, WISCONSIN

APPROVED
 JUL 19 1996
 CITY OF FITCHBURG, WISCONSIN

APPROVED
 JUL 19 1996
 CITY OF FITCHBURG, WISCONSIN

